

GS TW 34 NEO

General Specifications

Throat Diameter	72mm / 2,78"
Impedenza	4 ohm
Minium Impedance	3,8ohm <1,8 KHz
Power RMS	150W > 2.5KHz
Max Power (2)	200W > 2.5KHz
Frequency Range	2,5-20 KHz
Sensibility (1w - 1 mt)	105 dB
Sensibility (2.83v)	108 dB
Voice coil Diameter	34 mm / 1,33"
diaphragm material	Titanium

Parameter Thiele Small

Re (ohm)	3,8
Fs (hz)	3500
Le (mH)	0,045
Qts	2,7
Qms	9,30
Qes	3,8
Voice coil winding height (mm)	3,2
Voice Coil Wire	CCAW
Voice coil material	KSV

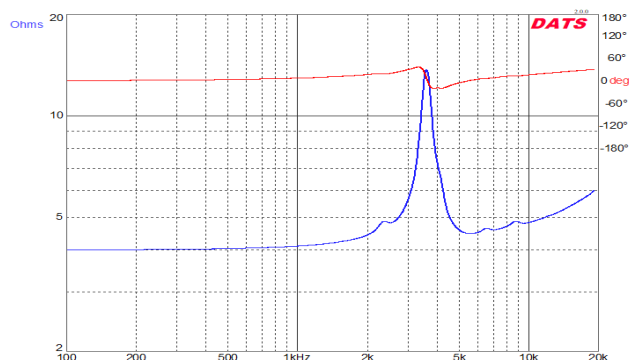

Drawing dimension / installation

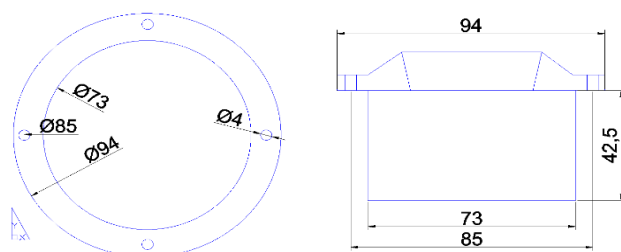

Technical Parameter

Magnet material	neodimium
Magnet dimension	33*10mm
Gap Height	2,5 mm
Power advice minium	20wrms
Terminal connection	Push terminal

Dimension Speaker / Package

Outer diameter	94 mm
Installation hole diameter	73 mm
Mounting depth	42,5 mm
Magnet diameter	73 mm
Volume speaker	0,15 Lt
Speaker Weight	0,45 kg
Pakage Weight	0,55 kg
Shipping box	10,4*10,4*6,8 cm cm



Crossover HPF passive advice

Crossover advice Hpf	3000 hz-18db	
C1= 6,1 uF	C2= 18,3 uF	L1= 0,23mH

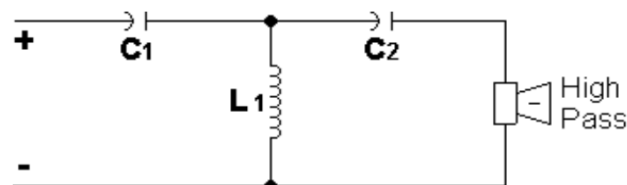

Gs Audio Srl

Via matteotti 220/A - San Possidonio MO - Italy
Whatsapp + 393473263458 - Mail: info@gsaudio.it