

GS TW 26 NEO

General Specifications

Throat Diameter	43mm / 1,65"
Impedenza	4 ohm
Minium Impedance	3,8ohm <1,5 KHz
Power RMS	90W > 1.5KHz
Max Power (2)	135W > 1.5KHz
Frequency Range	3-20 KHz
Sensibility (1w - 1 mt)	103 dB
Sensibility (2.83v)	106 dB
Voice coil Diameter	26 mm / 1,05"
diaphragm material	Titanium

Parameter Thiele Small

Re (ohm)	3,8
Fs (hz)	4000
Le (mH)	0,0477
Qts	0,19
Qms	0,29
Qes	0,55
Voice coil winding height (mm)	3,2
Voice Coil Wire	CCAW
Voice coil material	KSV

Technical Parameter

Magnet material	neodimium
Magnet dimension	25*8mm
Gap Height	2,5 mm
Power advice minium	10wrms
Terminal connection	Push terminal

Dimension Speaker / Package

Outer diameter	79 mm
Installation hole diameter	63 mm
Mounting depth	40 mm
Magnet diameter	63 mm
Volume speaker	0,14 Lt
Speaker Weight	0,4 kg
Pakage Weight	0,5 kg
Shipping box	10,4*8,6*6,8 cm cm

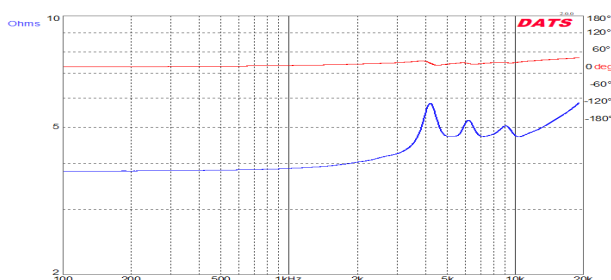

Crossover HPF passive advice

Crossover advice Hpf	3500 hz-18db	
C1= 7,6 uF	C2= 22,75 uF	L1= 0,13mH

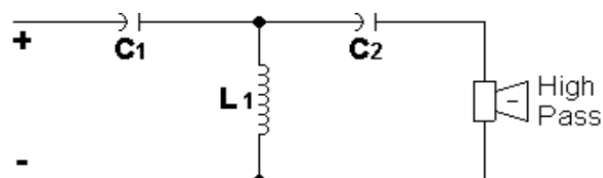

Drawing dimension / installation

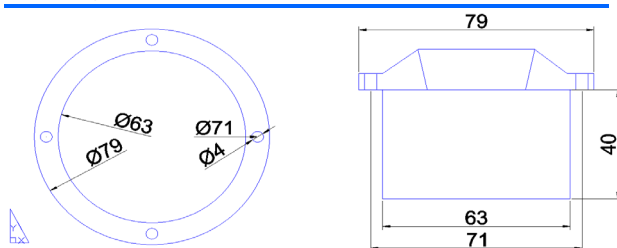

Gs Audio Srl

Via matteotti 220/A - San Possidonio MO - Italy
Whatsapp + 393473263458 - Mail: info@gsaudio.it